

FRONT

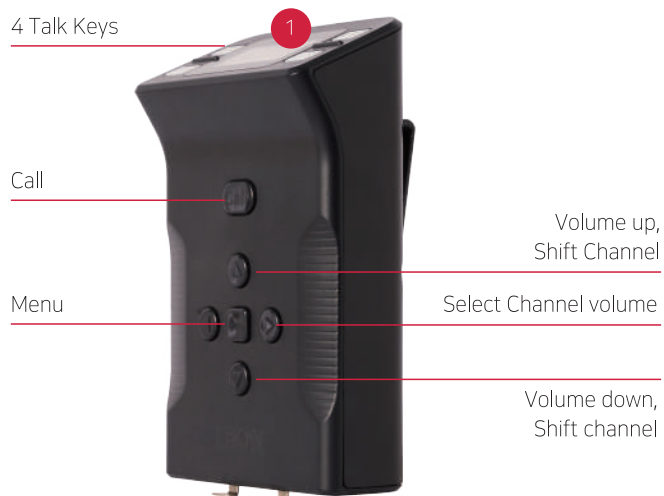

- 01 Display screen
- 02 Headset connector (6pin Mini-Din Receptacle)
- 03 Daisy-chain PoE In connector (RJ45, PD)

- 04 Daisy-chain PoE Out connector (RJ45)
- 05 3.5mm TRRS Headset (Earphone and Microphone) connector
- 06 Beltpack clip on rear

- ▶ 8 x Talk channels (main + shift) with 4 x Talk keys
- ▶ IP Beltpack can be connected to two(2) Base Stations at the same time for using 10 x Genie group conference channels.
- ▶ PoE In and PoE Out ports for a daisy-chain connection
- ▶ 6-pin mini-din connector headset port and TRRS headset port (Microphone and Earphone)
- ▶ Portable desktop use
- ▶ Configure at least one Remote Antenna to connect IP Beltpack with the Genie Base Station.
- ▶ Genie Line Router GLR4 in master mode enables to configure Genie wired system including IP Beltpack and Key Panel without Genie wireless devices.

IBP10 Specification

Genie Group Channels	Five(5) - ten(10)
Audio Bandwidth	200 Hz to 7.2 kHz
Headset Output	500mW into 32 Ohm
Headset	Dynamic or Electret, 6-pin mini-Din male
TRRS Headset	3.5Ø, Connect to Earphone or Audio I/O
Display	OLED
Button	4 Talk keys with LED indicator, Push buttons
Power Supply	Consumption: 4 watts Two RJ-45 Connectors, 100Mbps Standard PoE specification
Operating Temperature	0°C to 50°C (32°F to 122°F)
Dimensions	3.42W x 5.47D x 1.85H inch (8.75W x 13.9D x 4.7H cm) without Belt clip
Weight	0.68 lb (310g)